

***Measure Point: Vehicle**

*On the Siteworks upper left main screen tap the **Standing Rover Icon** to get to the **Measure Mode Settings Icon** screen.

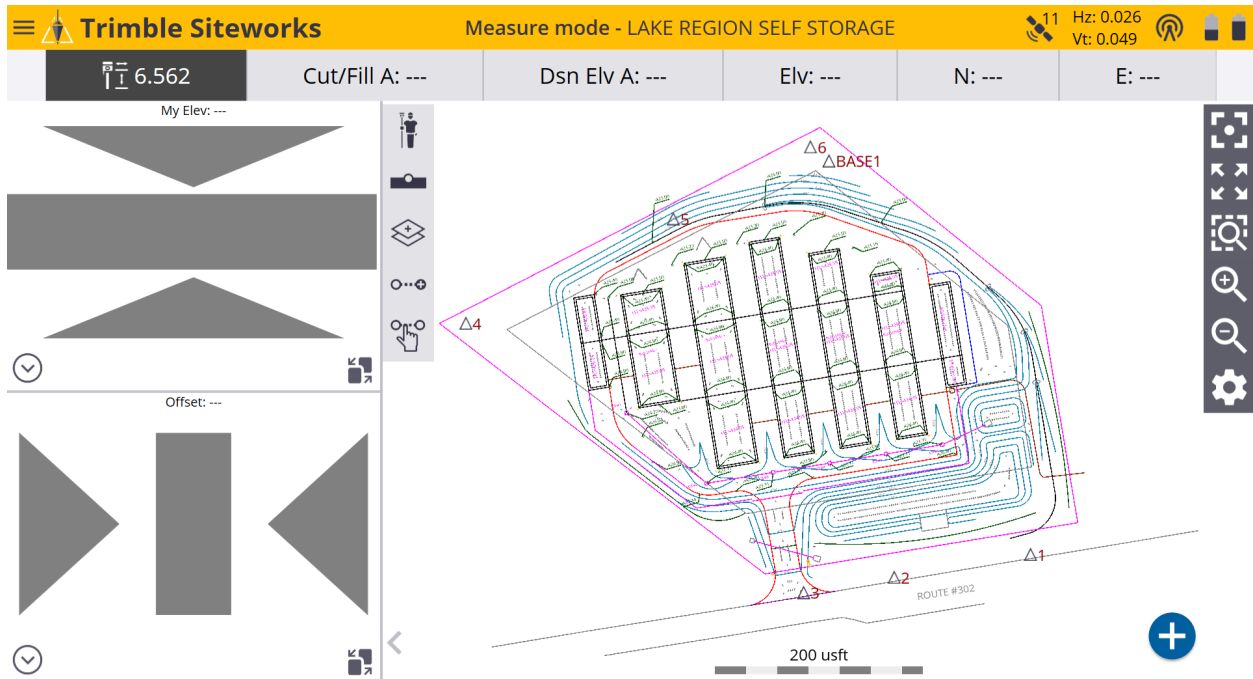

*On the **Measure Mode Settings Icon** screen tap on the blue **Vehicle Rover Icon** to get to the **Vehicle Mode Settings** screen.

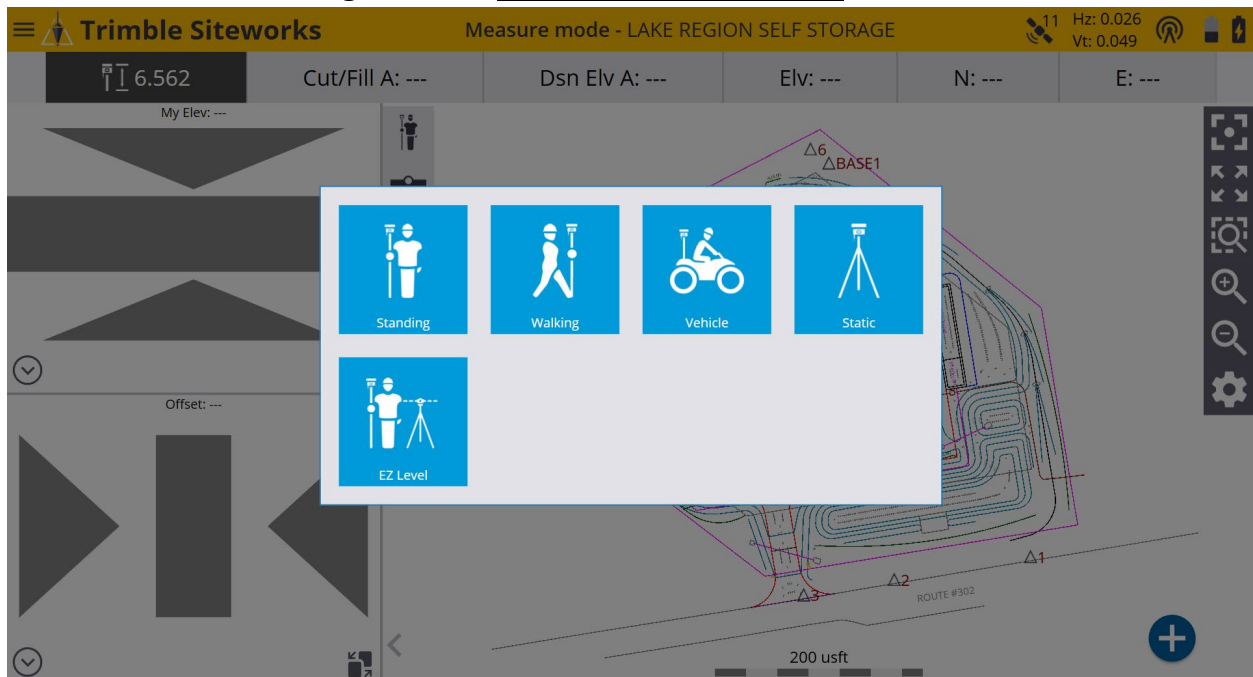

*On the **Vehicle Mode Settings** screen if you are using a quick release select **Yes** from the **Using Quick Release** window drop-down menu. Input the Antenna height in the **Vertical height** window. (*Usually 2 Meters/6.562 usft*)

The screenshot shows the 'Vehicle Mode Settings' interface. At the top, there is a status bar with icons for signal strength, frequency (Hz: 0.026), voltage (Vt: 0.049), and battery level. The settings are as follows:

Setting	Value
Using Quick Release	Yes
Vertical height	6.562 usft
Record mode	Fixed Distance
Horizontal interval	
Vertical interval	0.656 usft

An 'ACCEPT' button is located at the bottom right of the screen.

*On the **Vehicle Mode Settings** screen select **Fixed Distance** from the **Record mode** window drop-down menu, then input your desired **Horizontal interval** and **Vertical interval** values in their corresponding windows.

This screenshot shows the same 'Vehicle Mode Settings' interface after further configuration. The settings are now:

Setting	Value
Using Quick Release	Yes
Vertical height	6.562 usft
Record mode	Fixed Distance
Horizontal interval	16.404 usft
Vertical interval	0.656 usft

The 'ACCEPT' button remains at the bottom right, and a small circular icon with a blue arrow is visible in the bottom right corner of the screen.

*Tap the ? (*question mark*) to the right of the **Vertical height** window to enter the **Antenna Height** screen to visualize the antenna height configuration from the ground to the bottom of quick release, tap **X** in upper right corner to exit.

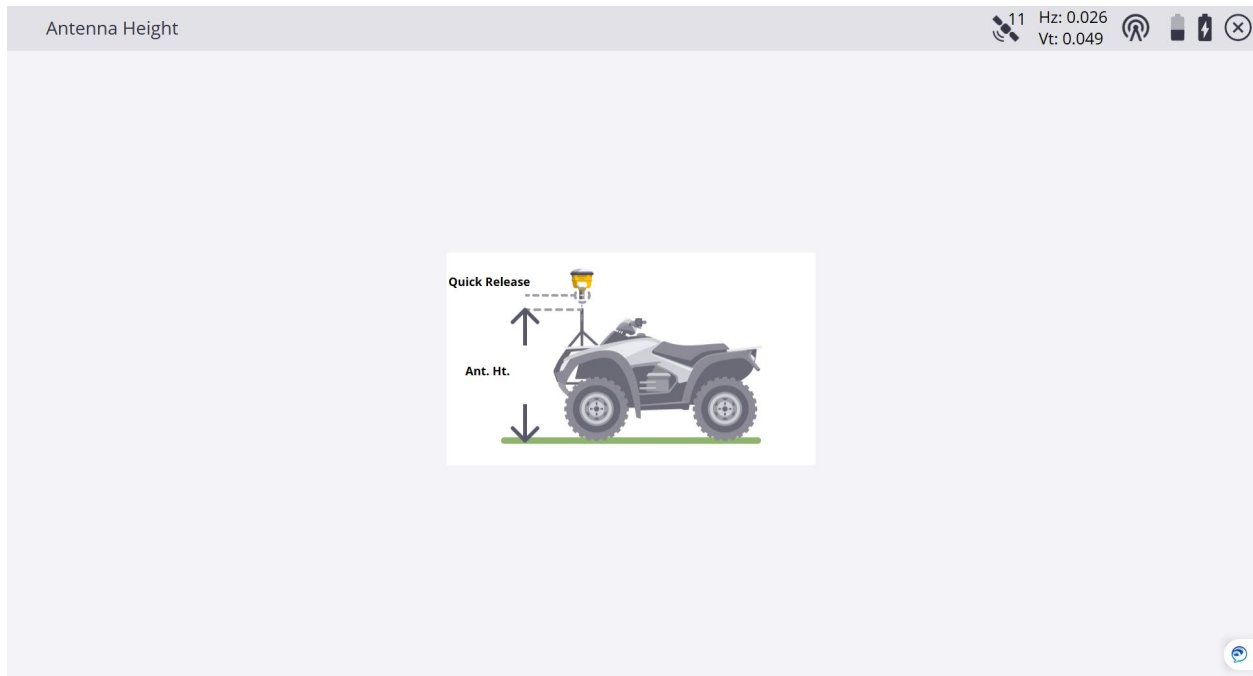

*On the **Vehicle Mode Settings** screen to the right of the **Vertical height** window tap the **Ruler Icon** to enter the **Measure Antenna Height** screen and input an elevation in the **Ground elevation** window.

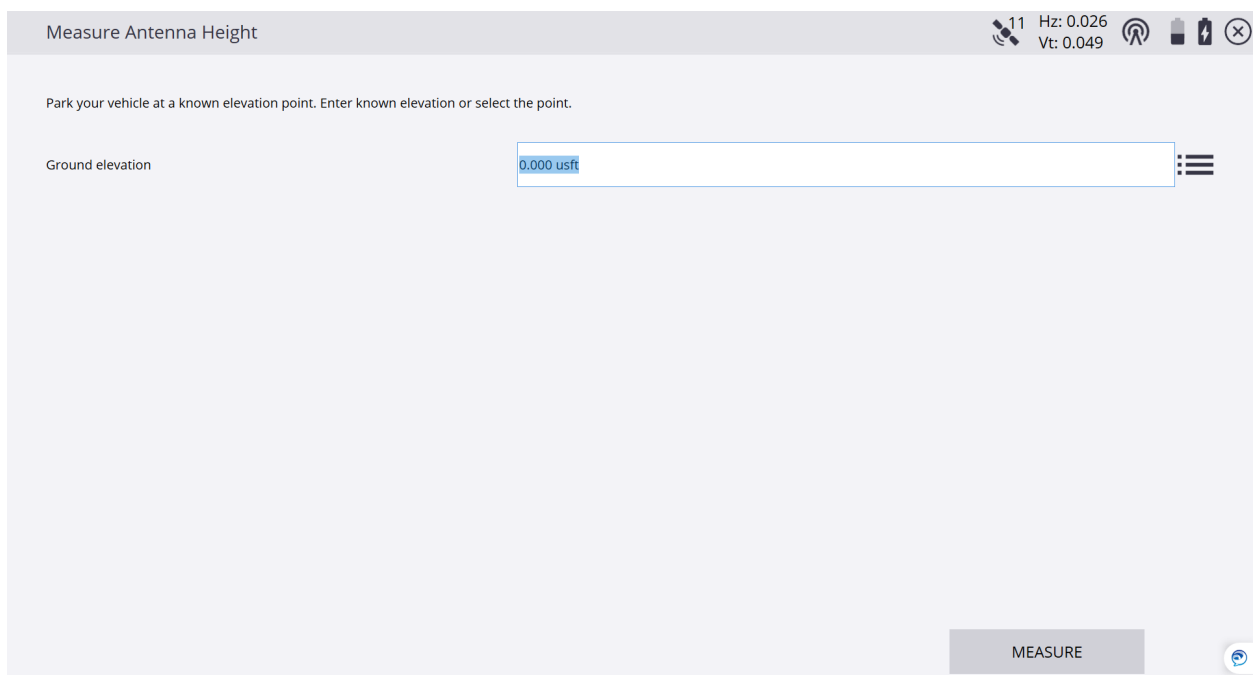

*You can also tap the **3-Dot/3-Bar Icon** to the right of the **Ground elevation** window to access the **Select point** screen and tap on a point to reference it's elevation, tap **ACCEPT** to get back to the **Measure Antenna Height** screen.

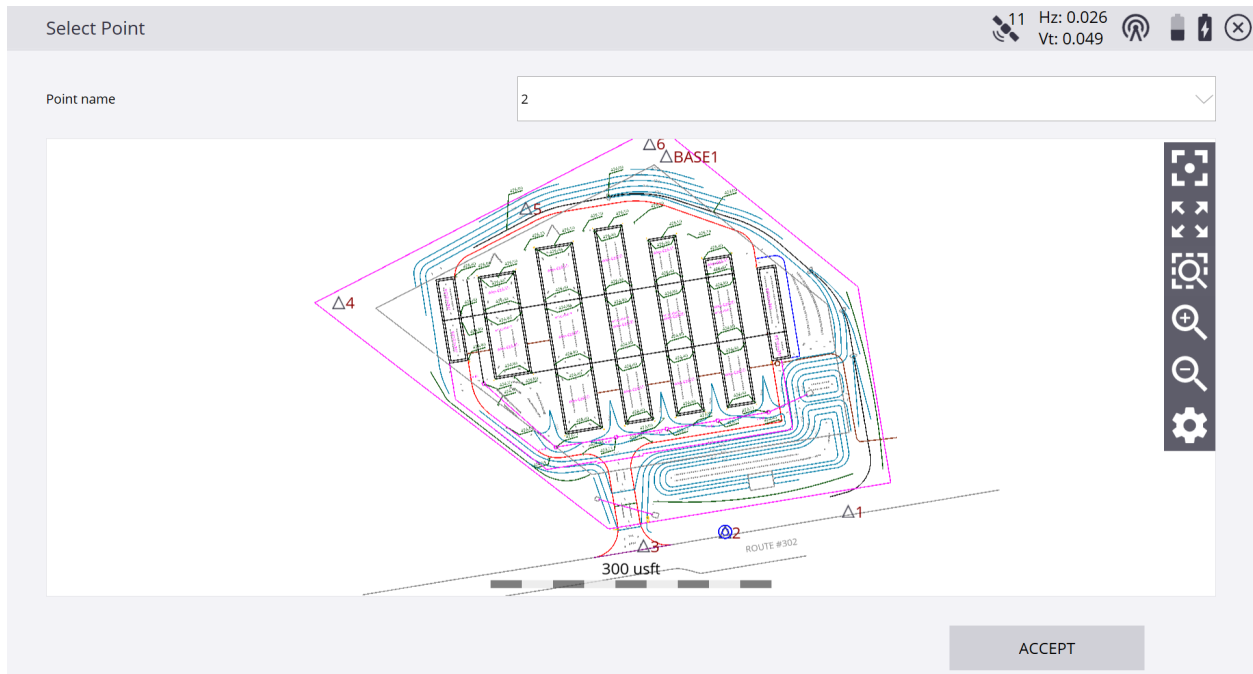

*Once you see the referenced elevation in the **Ground elevation** window on the **Measure Antenna Height** screen, tap **MEASURE**.

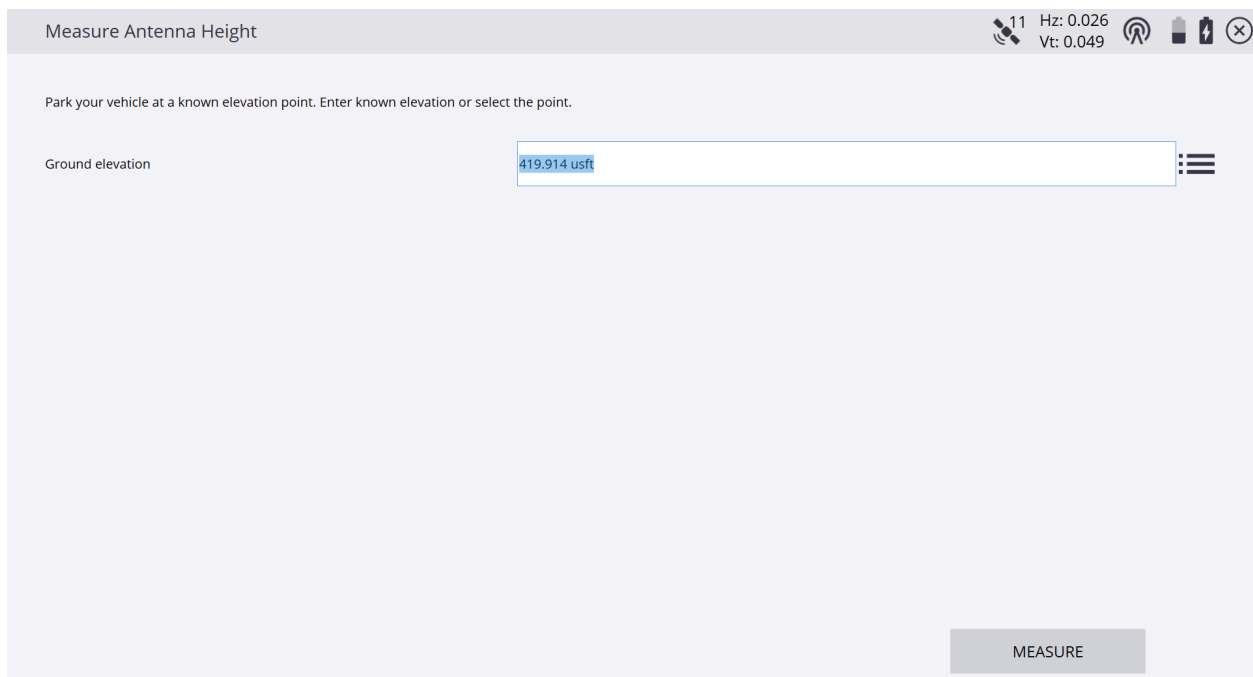

*On the **Vehicle Mode Settings** screen you will see the **Vertical height** change from referencing the point selected in the **Select point** screen, tap **ACCEPT**.

Vehicle Mode Settings

11 Hz: 0.026
Vt: 0.049

Using Quick Release

Yes

Vertical height

4.774 usft

?

Record mode

Fixed Distance

Horizontal interval

16.404 usft

Vertical interval

0.656 usft

ACCEPT

*Once back on the main **Measure mode** screen notice that the **Standing Rover Icon** is now the **Vehicle Rover Icon** which represents the **Measure mode** you are currently using. Tap the **Measure Type Icon** directly below the **Vehicle Rover Icon** to access the **Measure Type Screen** and select **Point**, **Existing Line** or **New Line**.

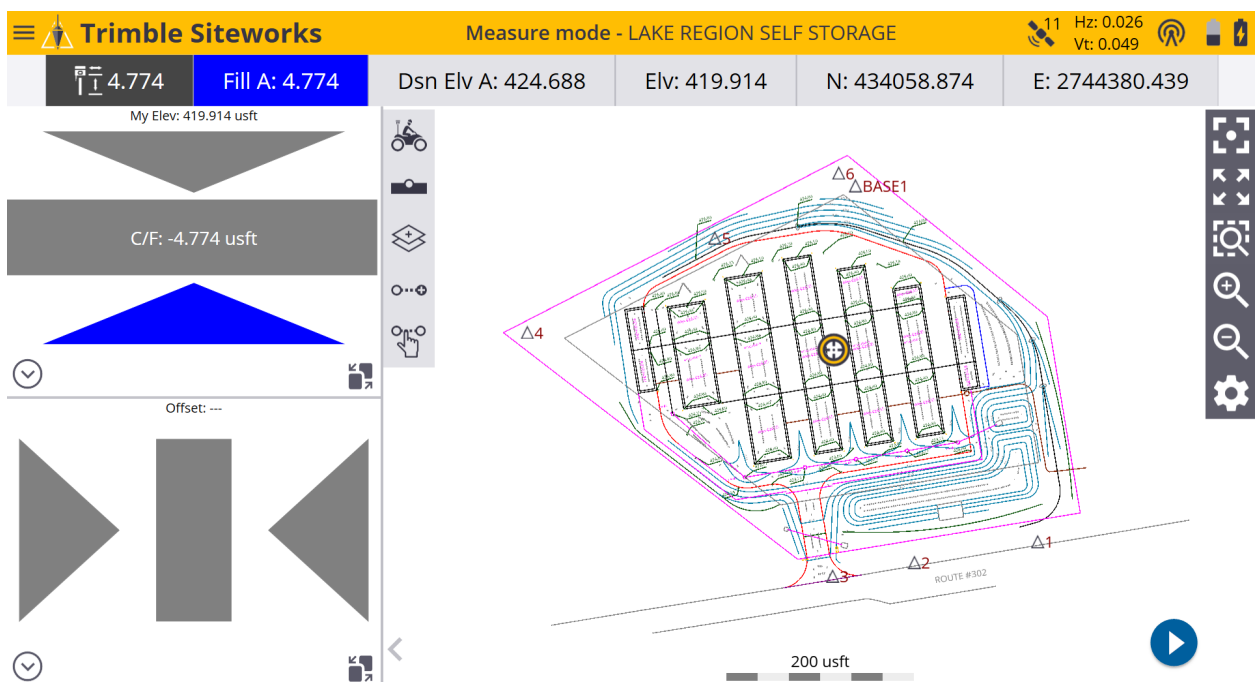

*Select **Point** and enter the starting **Point name** and **Point code** in their corresponding windows. For the **Point type** select **Surface** if you want the points to be used in a surface or **Feature** if you do not.

Measure Type

Point

Existing Line

New Line

11 Hz: 0.026 Vt: 0.049

Point name

Topo1

Point code

Point type

Surface

Show every time

Yes

☐ Create report after storing point

ACCEPT

*You can display the **Measure Type** screen every time after each measured point by selecting **Yes** or **No** from the **Show every time** window drop-down menu and **Create report after storing point** by checking the box to the left, tap **ACCEPT**.

